



DAVSGEMINI VALVES PVT LTD.

[SERIES 1100 F/E, SERIES 1100 S/E](#)

Y-TYPE ANGLE SEAT VALVE

COMPANY PROFILE:

DAVSGEMINI is high-tech Company which professionally Design and Develops Y-TYPE ANGLE SEAT VALVES. DAVSGEMINI is instituted to manage the quality control systems which assure all our products and service provided will meet the requirements of valve standards.

At DAVSGEMINI we believe in youthful power and creativity to establish our reliable quality and services. Our products are widely applied in various industrial fields, Air & Neutral gas, etc

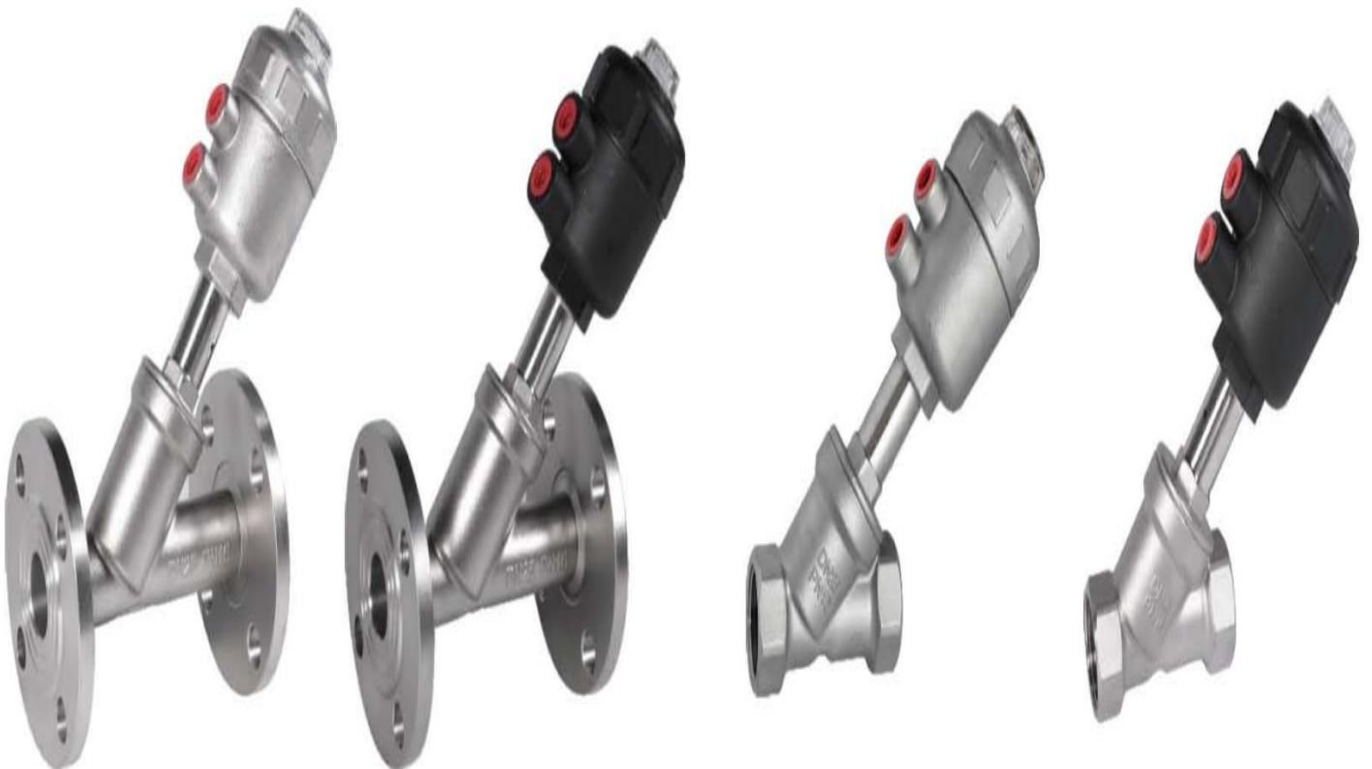

www.davsgeminivalves.com

DAVSGEMINI VALVES PVT LTD.

SERIES 1100 F/E

Y –TYPE ANGLE SEAT VALVE

PRODUCT DESCRIPTION :

Pneumatic angle seat valves are widely used in short-term frequent starts, with sensitive response and accurate motion characteristics. Combined with the use of solenoid valves, pneumatic control can precisely control the flow of gas and liquid. It can realize the requirements of correct temperature control, liquid dripping and so on.

Pneumatic angle seat valves can be divided into single-acting and double-acting. Single-acting: The pneumatic head is usually a hole, which can be divided into normally open type and normally closed type according to the function of opening and closing by spring reset. Double action: The pneumatic head usually has two holes, and the air supply controls its switch.

SPECIFICATIONS :

Y-TYPE ANGLE SEAT VALVE FLANGED END

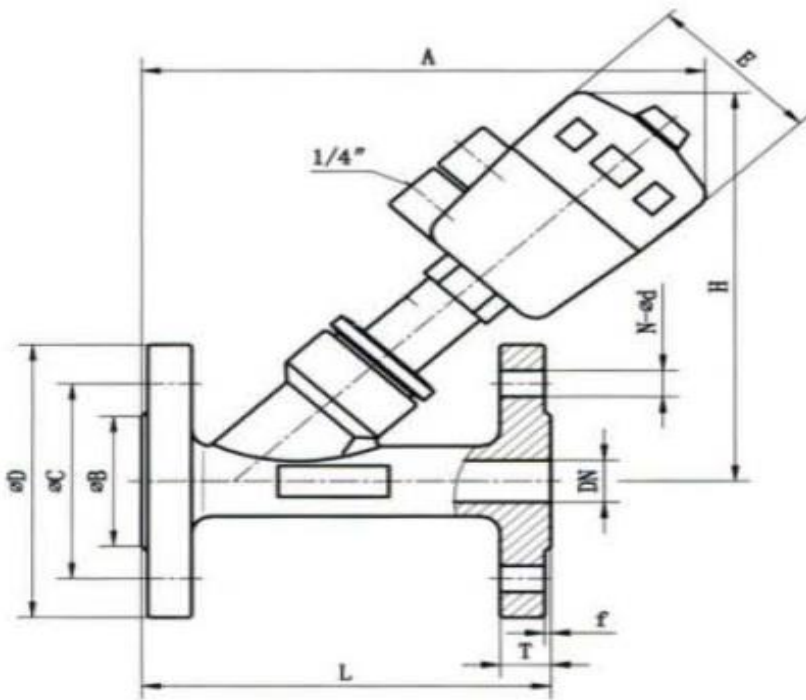

Technical Parameter:

Medium temperature: -20°C ~ +135°C,
20°C~ +180°C
Ambient temperature : -20°C ~ + 60°C
Nominal pressure : 1.6Mpa
Specification: DN 15~ DN 100
Control gas: neutral gas ,air
Gas source pressure : 0.3~0.8Mpa
Valve body material: CF8,CF8M
Seat material : PTFE
Stem material : SS304
Sealing ring material : NBR
Flange drill standard : ASME B 16.5
Face to Face : Manufacturing STD.

DN	Dimensions Data in mm									
	L	T	f	D	C	B	A	H	E	N – Ød
15	120	10	2	90	60.3	35	180	137	62	4 – Ø16
20	130	11	2	100	69.9	43	180	145	62	4 – Ø16
25	141.5	14	2	110	79.4	51	180	165	62	4 – Ø16
32	150	16	2	115	88.9	63.5	205	170	75	4 – Ø16
40	181.5	17	2	130	98.4	73	215	181	75	4 – Ø16
50	196.5	17.5	2	150	120.7	92	224	195	75	4 – Ø18
65	232.5	19.7	2	180	139.7	105	270	230	95	4 – Ø18
80	250	20.5	2	190	152.4	130	320	270	120	4 – Ø18
100	295	25.3	2	230	190.5	157.2	360	350	156	8 – Ø18

SPECIFICATIONS :

Y-TYPE ANGLE SEAT VALVE SCREWED END

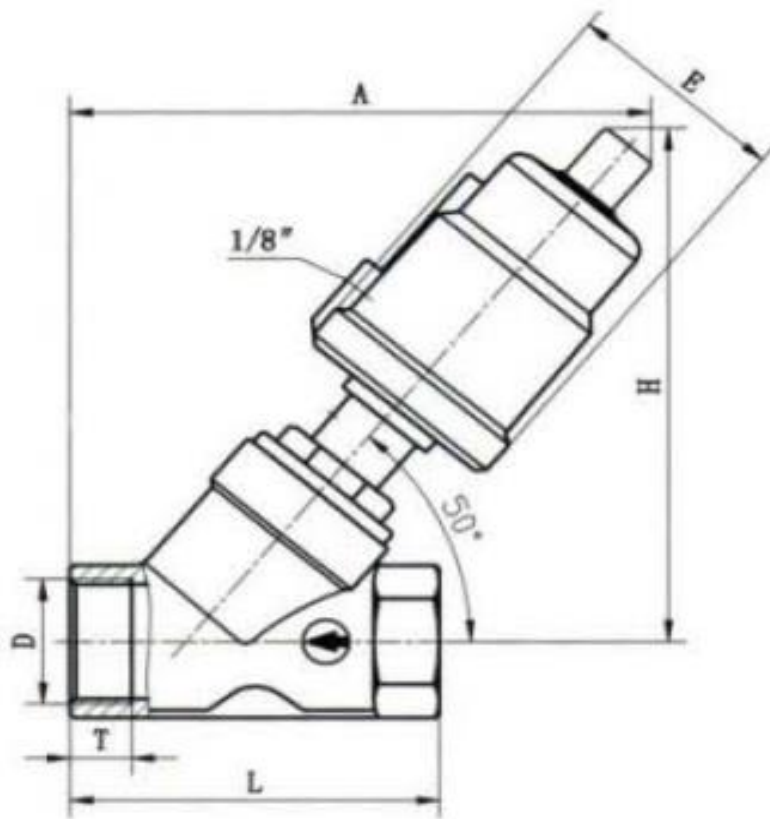

Technical Parameter:

Medium temperature: -20°C ~ +180°C
 Ambient temperature : -20°C ~ + 60°C
 Nominal pressure : 1.6Mpa
 Specification: DN 15~ DN 100
 Control gas: neutral gas ,air
 Gas source pressure : 0.3~0.8Mpa
 Valve body material: CF8,CF8M
 Seat material : PTFE
 Stem material : SS304
 Sealing ring material : NBR

DN	Dimensions Data in mm					
	L	T	H	A	D	E
15	68	11	133	126	1/2"	62
20	75	14	137	131	3/4"	62
25	90	15	140	155	1"	62
32	115	17.5	188	175	1 1/4"	76
40	115	17.5	190	178	1 1/2"	76
50	135	20	215	225	2"	76
65	185	30	252	280	2 1/2"	96
80	208	33	280	320	3"	114
100	235	33	300	350	4"	114



DAVSGEMINI VALVES PVT LTD.

SERIES 1100 F/E, SERIES 1100 S/E

Y –TYPE ANGLE SEAT VALVE

APPLICATIONS:

- The application fields of angle seat valves are also very extensive. Pneumatic angle seat valves are widely used in industries such as beer, textile printing and dyeing and bleaching, pharmaceuticals and medical equipment, food processing, rubber machinery, organic and inorganic chemicals, cleaning, disinfection, high temperature sterilization, water treatment, etc.
- The medium is water, liquid, neutral gas, water vapor, slightly corrosive gas and liquid. Compared with other valves, it has the characteristics of economical investment, safe use, maintenance-free and long life.



DAVSGEMINI VALVES PVT LTD.

REGD.OFFICE

SAHIL RESIDENCY F NO.3 BLDG A, B –WING SECTOR NO.9

PLOT NO.17 MOSHI PCNTDA PUNE412105

sales@davsgeminivalves.com

info@davsgeminivalves.com

www.davsgeminivalves.com



www.davsgeminivalves.com